

Distribution

2 Copies

King County Solid Waste Division
Department of Natural Resources and Parks
King Street Center
201 South Jackson Street, Suite 701
Seattle, Washington 98104-3855

Attention: Mr. Jim Neely

Figures

P:\19897\61926\ FIG-1 01/18/08 07:39 riehepj XREFS: 8X11BDR

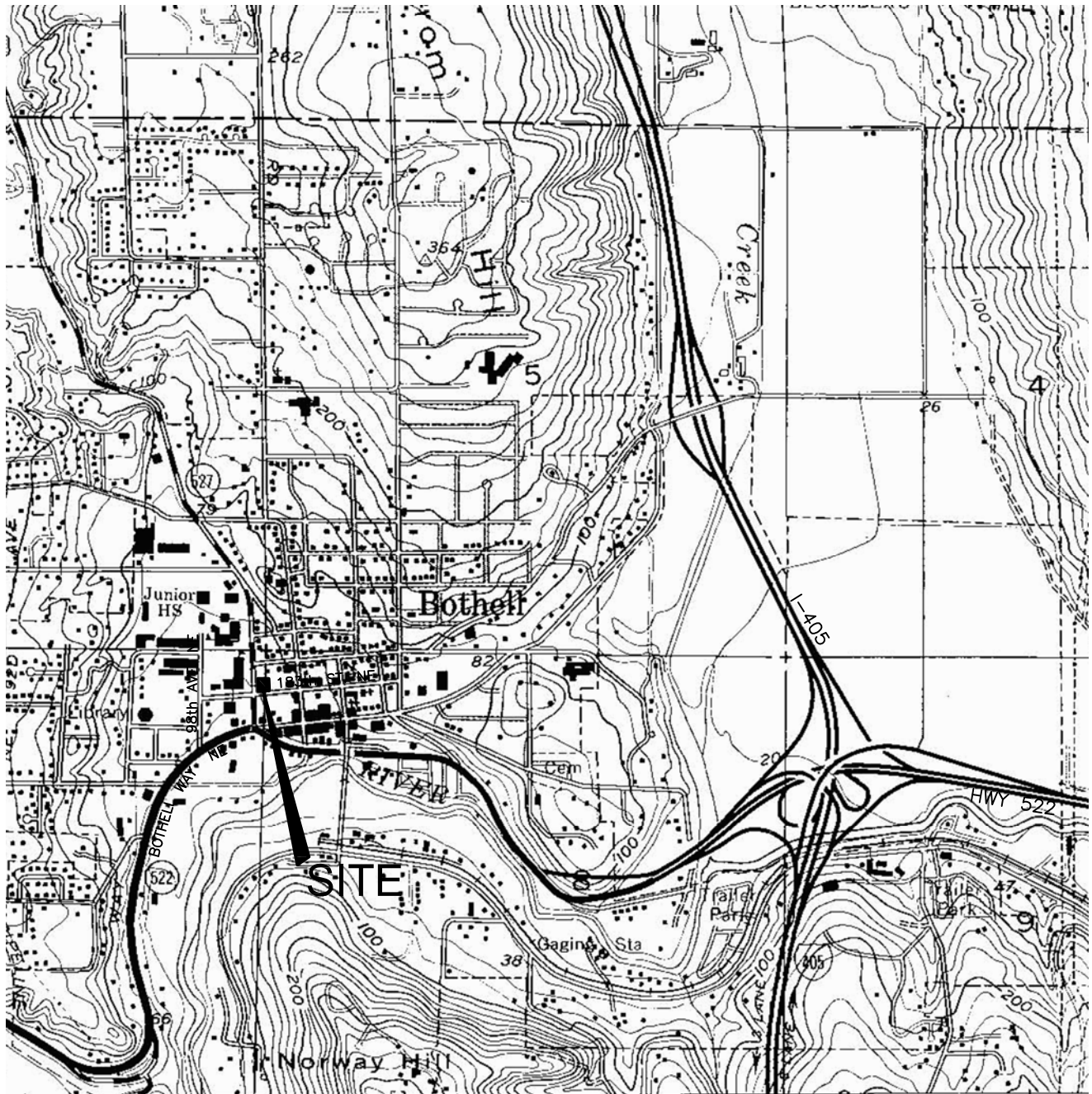

Source: USGS Bothell, Wash. 7.5' Quadrangle, 1981

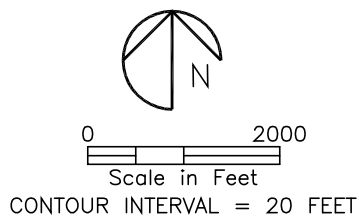

Washington

FORMER ULTRA CUSTOM CLEANERS SITE
18304 BOTHELL WAY NE
BOTHELL, WASHINGTON

Figure No. 1
Vicinity Map



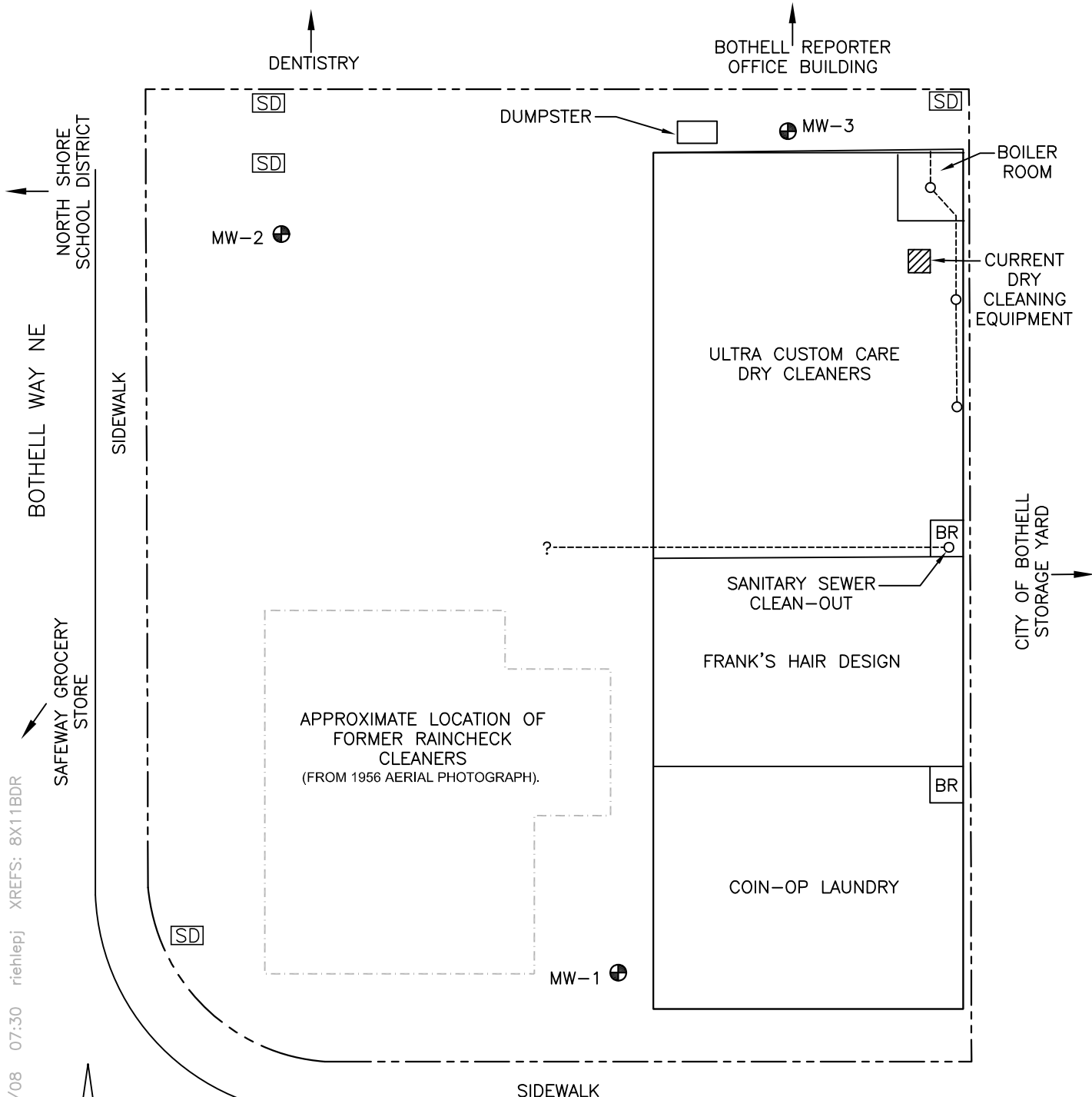

P:\19897\61926\ FIG-2 01/18/08 07:30 riehlepj XREFS: 8X11BDR

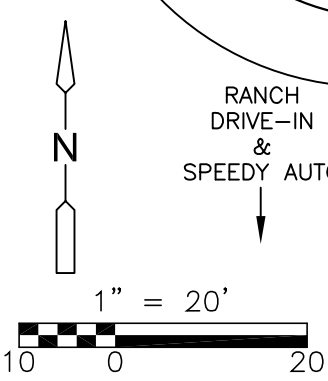

REFERENCE: ENVIRONMENTAL PARTNERS INC,
PROJECT NO.46101.0, DATED 11/29/2004.
AND FARALLON CONSULTING, FIGURE 3, DATED
4/16/02

- LEGEND:**
- MW-1 MONITORING WELL LOCATION AND DESIGNATION
 - SD STORMDRAIN
 - FLOOR DRAIN
 - PROPERTY LINE
 - BR BATHROOM

FORMER ULTRA CUSTOM CLEANERS SITE
18304 BOTHELL WAY NE
BOTHELL, WASHINGTON

Figure No. 2
Site Plan

