

Conceptual Streetscape Design Elements for Future Main Street Corridor

Desirable Outcomes

1. Emphasis on gathering areas or public spaces

How has the Conceptual Streetscape design addressed this?

Gathering spaces on existing Main Street are confined to the mid-block portion only.

- The concept provides opportunities for gathering areas in the mid-block area, at the intersection corners, and in the flexible use zones (seasonal).
- Provides a 36% increase in the square footage of area available for public use.



2. Emphasis on wide pedestrian- friendly sidewalks

Sidewalks along existing Main Street vary from 8' – 12' in alternating sections on both sides of the existing street.

- The concept provides for uniform distribution of 12 foot sidewalks on each side of the street.
- Provides pavement treatment options that create interest, provide texture and distinguish the pedestrian zone.
- Layout promotes free-flowing (uncongested) and more open street atmosphere.
- Provides opportunities to accommodate street furniture and sidewalk activities.



3. Emphasis on additional store-front parking

Parking along existing Main Street consists of a total of 42 angle-parking spaces in intermittent sections on alternating sides of the existing street.

- The concept provides for uniform and democratic distribution of parallel-parking available on both sides of the street.
- Provides a total of 64 parking spaces in the existing 3 blocks (an additional 22 spaces i.e. a 52% increase in parking)
- Provides up to 30 new parking spaces on the Extension side, in the new block between SR 527 to 98th Ave NE.
- Exceeds the minimum requirements for ADA compliance by providing an overall parking scheme whereby all 94 parking spaces are accessible for ADA use without ramps (flush curb condition).



Conceptual Streetscape Design Elements for Future Main Street Corridor

4. Emphasis on maintaining the street character

Existing Main street has an intimate, unique, small town feel.

- The concept maintains this overall feel by incorporating historic elements in the street furniture and building upon the existing urban elements that promote this distinct small town appeal.



5. Emphasis on enhanced business visibility

Visibility of the store fronts along existing Main Street is obscured by the landscaping, planting and tree choices, the street's curvilinear layout and visual density of the (deeper) angle parking.

- The concept provides clear lines of sight for the street with a linear street layout and parallel parking in front of the stores.
- Provides tree selection options using columnar type trees that have less spread and are placed far back from the building awnings.
- Provides options for trees in planter boxes that raise the height of the tree canopy bottom; and low ground shrubs that do not obscure the store fronts.
- Provides tree spacing options that enhance visual openings that expose the store front to pedestrian and auto traffic.



6. Emphasis on traffic calming measures

Existing Main street is auto-biased i.e. not pedestrian-friendly.

- Clearly defined pedestrian zones emphasized by enhanced pavement treatment.
- The concept provides 'visual texture' with a pedestrian bias that makes the travel lanes feel narrower, and thus encourages autos to drive slowly.



Conceptual Streetscape Design Elements for Future Main Street Corridor

7. Emphasis on high-visibility or enhanced pedestrian crossings

Crosswalks at intersections or mid-block are not pedestrian-friendly.

- The concept provides intersection and mid-block crosswalks with enhanced pavement treatment that provides color contrast which clearly demarcates the pedestrian crossing zone.
- Incorporates pedestrian-scale street lighting at intersections and mid-block crossings to enhance pedestrian visibility.
- Provides pavement treatment options that are ADA-friendly and heel-friendly.

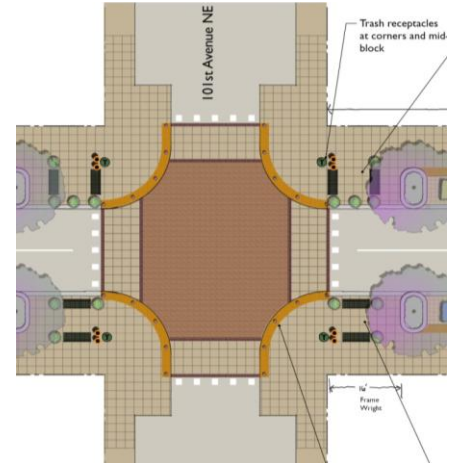

8. Flexible Use Zones

Proposed urban concept that would be implemented seasonally by converting parking areas for various public uses such as: outdoor café seating, street festivals, parades and events, street markets, street vendors, musical performances, public art displays etc.

- The flexible zone concept provides opportunities to favor more parking or more gathering areas as the season dictates.
- As a pedestrian zone, expands the pedestrian realm by an additional 67% and provides gathering space opportunities.
- As a parking zone, expands the auto zone and addresses parking deficiencies on the street.



9. Incorporation of other features:-

- Inclusion of public art and sustainable design opportunities.
- Versatility - ability to convert public spaces to other uses as needed

